



# 26 TAMARACK DRIVE

MLS® #: NB102582



# WELCOME

---

## TO YOUR NEW HOME

Located in Tamarack Park, 26 Tamarack Drive on a distinctive lot that offers extra privacy, this mini home features a well-thought-out floor plan that maximizes every inch of space.

Approximately 840 square feet of living area includes 2 bedrooms and 1 bathroom. The open-concept living room and kitchen area create a welcoming environment, perfect for entertaining guests or enjoying quiet evenings at home.

The kitchen is equipped with modern appliances, ample cabinetry, and a convenient eat-in dining area. The two bedrooms are located at the opposite ends of the home, providing lots of privacy. A full bathroom completes this home.

Outside, a large deck provides the perfect spot for your morning coffee or evening relaxation. Two storage sheds are a great use to store all your extra belongings.





## BRIGHT INTERIOR

The main living area is spacious with the kitchen opening up to the living room space; perfect for connecting with friends and family. The vaulted ceiling adds a nice touch.



## GREAT LAYOUT

Two bedrooms at opposite ends of the home for maximum privacy. The primary bedroom is near the updated main bathroom and hallway laundry looking out over the woods.

## SPACIOUS DECK

The exterior space includes an expansive deck with space for the whole family. Lattice for privacy and stairs at either side are a great addition.



## TREE LINED LOT

Situated next to the bridge in Tamarack Park, this home is partially surrounded by mature trees for unrivalled privacy and has two storage sheds.



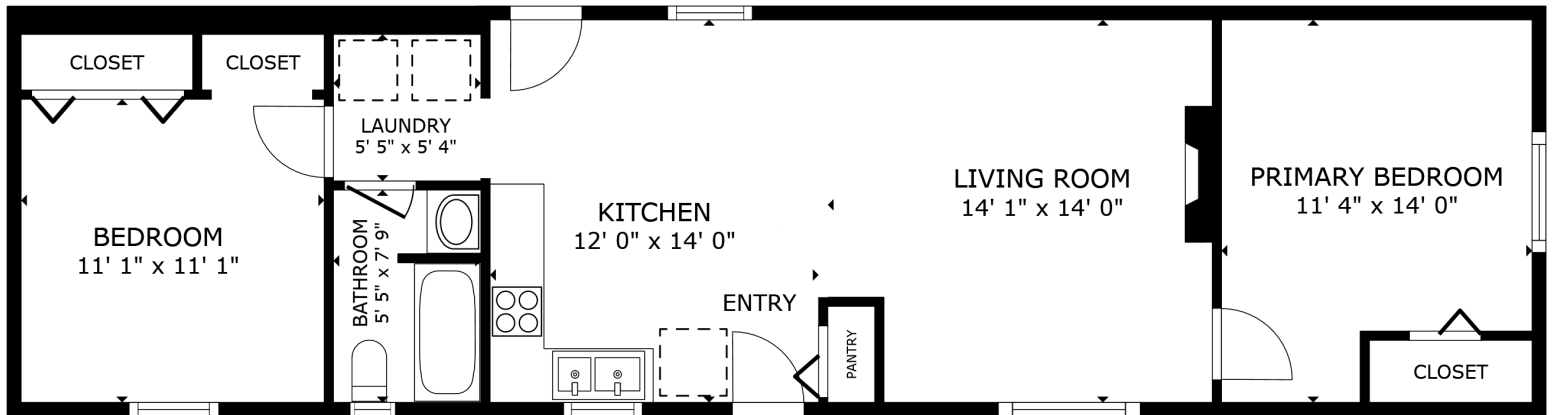

GROSS INTERNAL AREA  
FLOOR PLAN 763 sq.ft.  
TOTAL : 763 sq.ft.

SIZES AND DIMENSIONS ARE APPROXIMATE, ACTUAL MAY VARY.

