

29 COUNTRY LANE

ISLAND VIEW, NEW BRUNSWICK

A warm and thoughtfully upgraded 5-bedroom two-storey home in Island View with a pool, finished basement, and modern charm—ideal for family life, entertaining, and enjoying nature year-round.

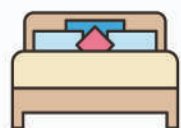



4+1
Bedrooms

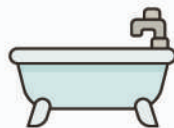

2.5
Bathrooms



5,184
Square Feet

Welcome to 29 Country Lane, a meticulously maintained 5-bedroom home that blends classic character with modern upgrades in the peaceful community of Island View. From the moment you arrive, you'll appreciate the timeless curb appeal with upgraded exterior columns and manicured landscaping.



LOWER LEVEL

MAIN LEVEL

SECOND LEVEL

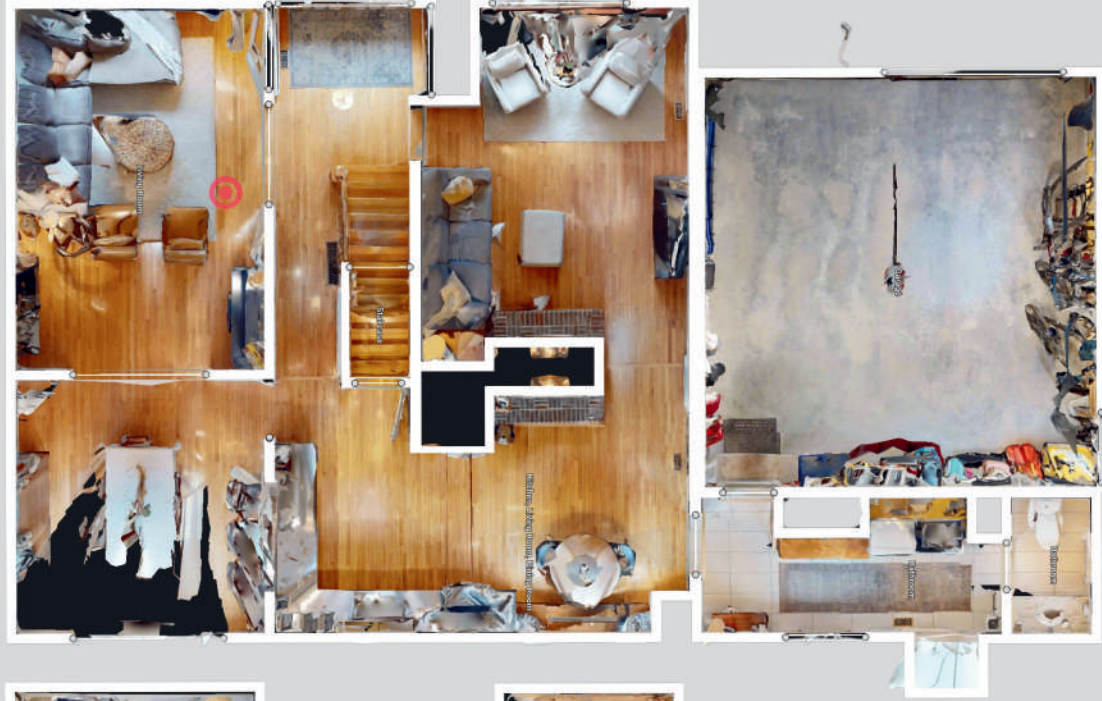



FEATURES & UPDATES

A CLOSER LOOK AT WHAT MAKES THIS HOME SPECIAL AND THE WORK THAT HAS BEEN DONE

Interior:

- Kitchen remodel (2017) with additional pantry/bench (2022)
- Stainless steel fridge, oven (2023), dishwasher (2022)
- Mudroom & half bath renovation (2020)
- Basement refresh (2020): paint, flooring, trim, lighting, built-ins
- Updated trim throughout main level (2018–2022)
- Insulated aluminum door in mudroom (2022)
- Exterior generator connector added to sub-panel (2023)

Windows & Doors:

- Extreme aluminum-clad vinyl windows (2018): front and side
- Vinyl windows in mudroom and bath (2020)
- Window above kitchen bench (2022)

Exterior Improvements:

- Rebuilt column bases (2019)
- Chain-link fence (2021)
- Semi-in-ground pool with stair entry & heat pump (2021)
- Stone patio (2021)
- 2-tier back deck (2023)
- Garage spring (2020), cable (2023)

Systems & Efficiency:

- High-efficiency wood furnace (2017)
- NB Power: approx. \$292.30/month
- Propane: approx. \$500/year
- 2 cords of wood used per year





MAIN LIVING SPACE

BRIGHT, TRADITIONAL DESIGN

The main floor offers a bright, functional layout with a renovated kitchen (2017) flowing into a cozy living room with a double-sided propane fireplace. A formal dining room, second living space, updated mudroom and half bath (2020), and easy access to the 2-tier deck make this level perfect for everyday living and entertaining.





SECOND LEVEL

QUIET RETREATS FOR ALL

Upstairs, you'll find four generously sized bedrooms, thoughtfully arranged to provide privacy and comfort for every member of the family. The primary suite is particularly impressive, offering a spacious retreat with its own private ensuite bathroom. Large windows throughout the upper level ensure plenty of natural light, and the updated trim and maintained hardwood flooring carry the home's timeless charm into every room. This level provides plenty of space for family life, home offices, or guest accommodations.



LOWER LEVEL

EXTRA SPACE FOR THE WHOLE FAMILY

The fully refreshed basement (2020) offers a bright and functional extension of the living space. It features a large family room, custom built-ins, and flexible areas that can easily adapt to a home gym, playroom, media room, or additional guest space. Fresh paint, updated flooring, modern lighting, and new trim create a polished, cohesive look. The basement is perfectly set up for casual living and provides lots of additional storage options as well.





WHY WE LOVE THIS PLACE

A NOTE FROM THE HOMEOWNERS

“We’ve loved living at 29 Country Lane since 2017—it’s been a warm, cozy, and joy-filled home for our family. From snowy mornings by the wood furnace to sunny pool days and evening gatherings on the back deck, every season here brings something special.

The large windows fill the house with light, and the charm of the hardwood floors and fireplaces instantly made it feel like home. Our kids learned to ride their bikes on these quiet streets and slid down the side hill every winter. This community is private, peaceful, and welcoming—with well-kept homes and a true sense of pride.

We’re excited for the next family to enjoy everything this home has to offer.”



GRADES K - 5
Kingsclear Community School



GRADES 6 - 8
George Street Middle School



GRADES 9 - 12
Fredericton High School

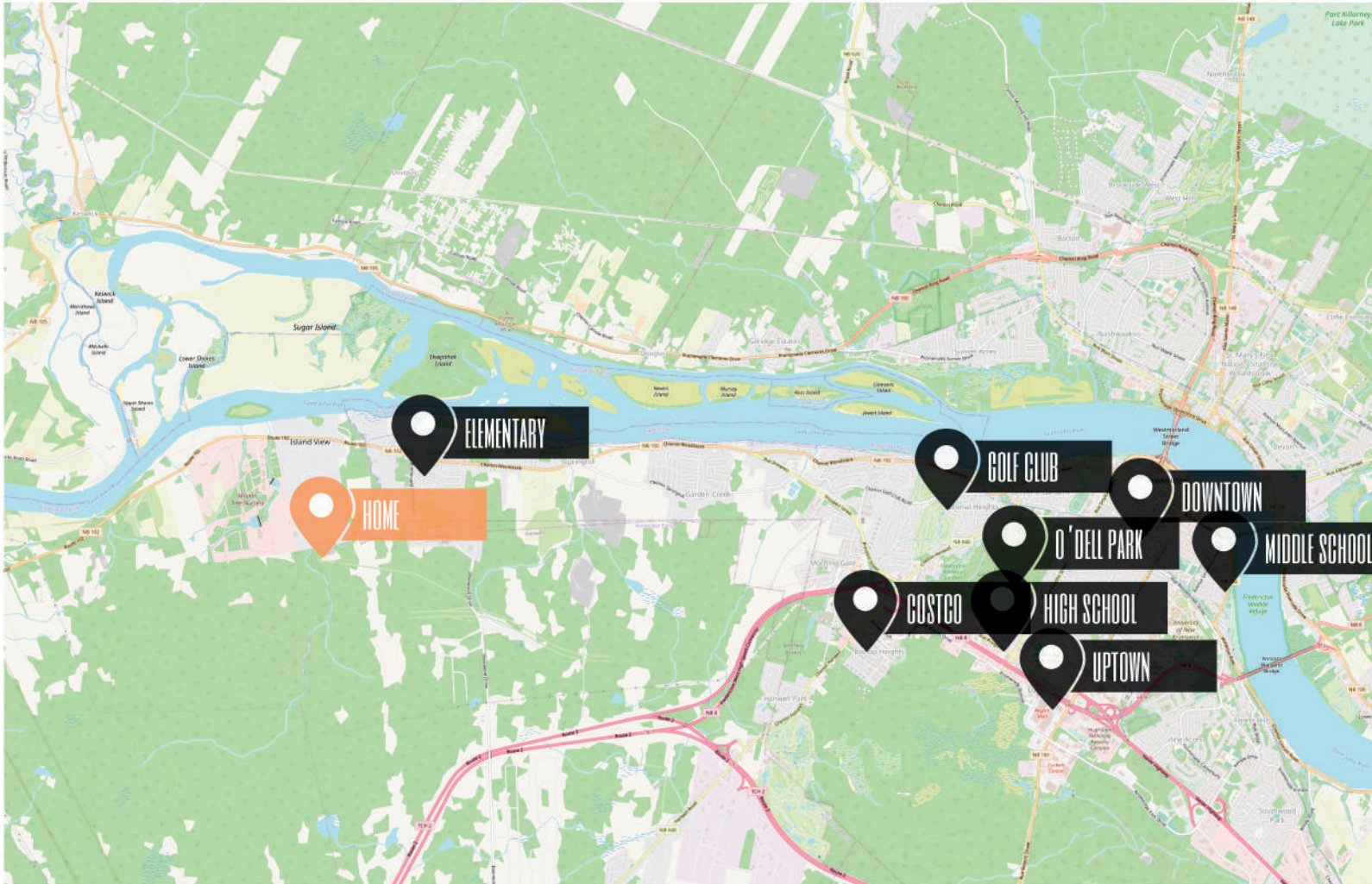

NEIGHBOURHOOD & SCHOOLS

COMFORTABLE & SPACIOUS RETREATS

29 Country Lane is located in the welcoming community of Island View, a neighbourhood that perfectly balances privacy and a true sense of community. Here, you'll find generous lot sizes, tree-lined streets, and a variety of well-kept, unique homes. The area is known for its peaceful atmosphere, making it a fantastic spot for walking, biking, and raising a family.



www.therightchoicerealty.ca

This is not intended to solicit those who are currently working with another real estate company – we cooperate fully with other agents